

# CHARLES L. TATE, JR. AND ASSOCIATES

## CONSULTING FORESTER AND REAL ESTATE BROKER

POST OFFICE BOX 668  
 LAKE WACCAMAW, NORTH CAROLINA 28450

TELEPHONE: 910-646-3764  
 FAX: 910-646-4429

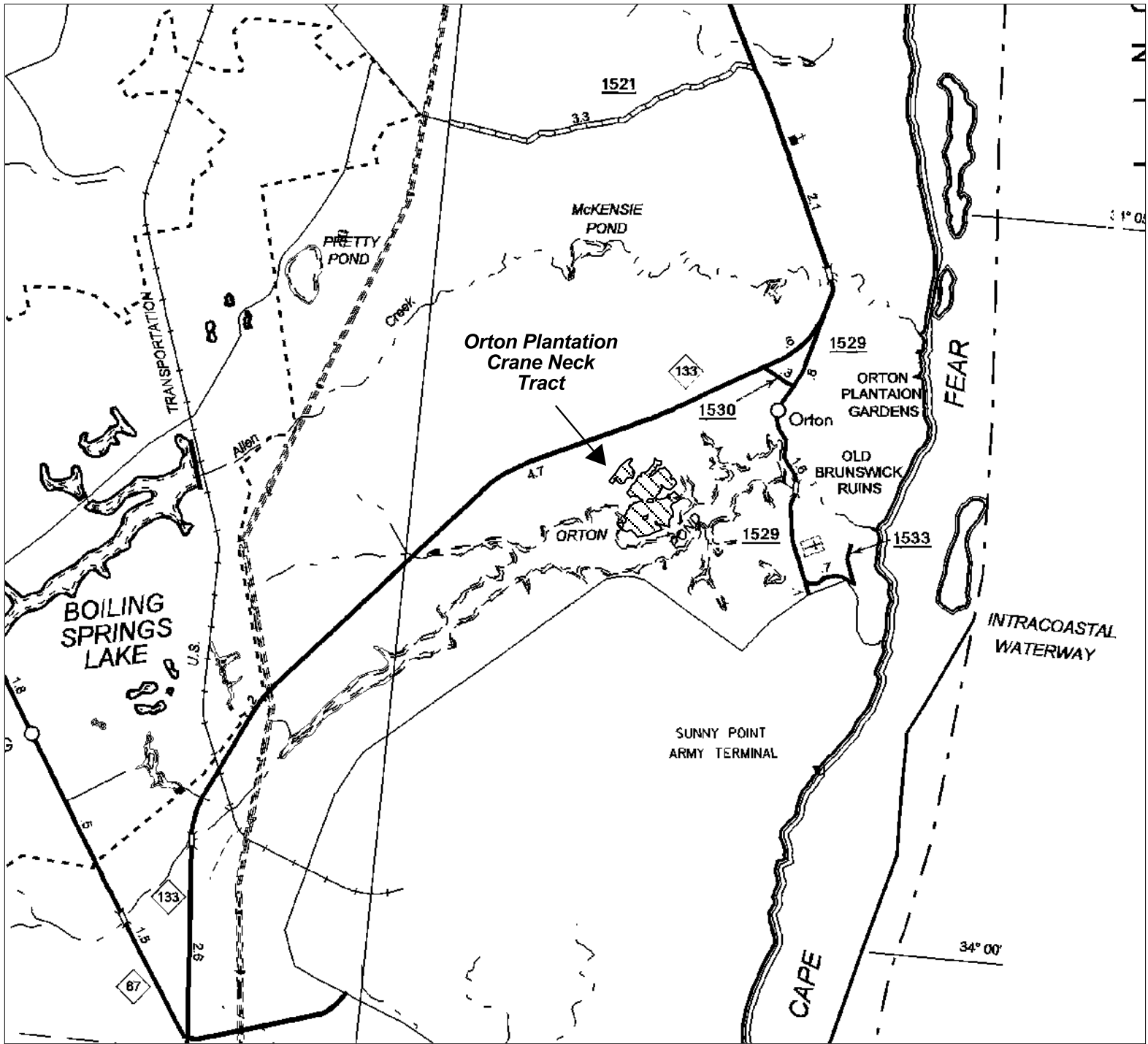

LEGEND	
TRACT BOUNDARY	—————
TIMER TYPE BOUNDARY	- - - - -
PUBLIC ROAD	=====
PRIVATE ROAD	-----
RAILROAD	—————+—————
POWERLINE	———+———
CREEK	~~~~~
CANAL / DITCH	.....
BUILDINGS	■ ■ ■ ■ ■

# ORTON PLANTATION

## CRANE NECK TRACT

COUNTY: BRUNSWICK

TOWNSHIP: SMITHVILLE

NOT TO SCALE