

CHARLES L. TATE, JR. AND ASSOCIATES

CONSULTING FORESTER AND REAL ESTATE BROKER

POST OFFICE BOX 668
LAKE WACCAMAW, NORTH CAROLINA 28450

TELEPHONE: 910-646-3764
FAX: 910-646-4429

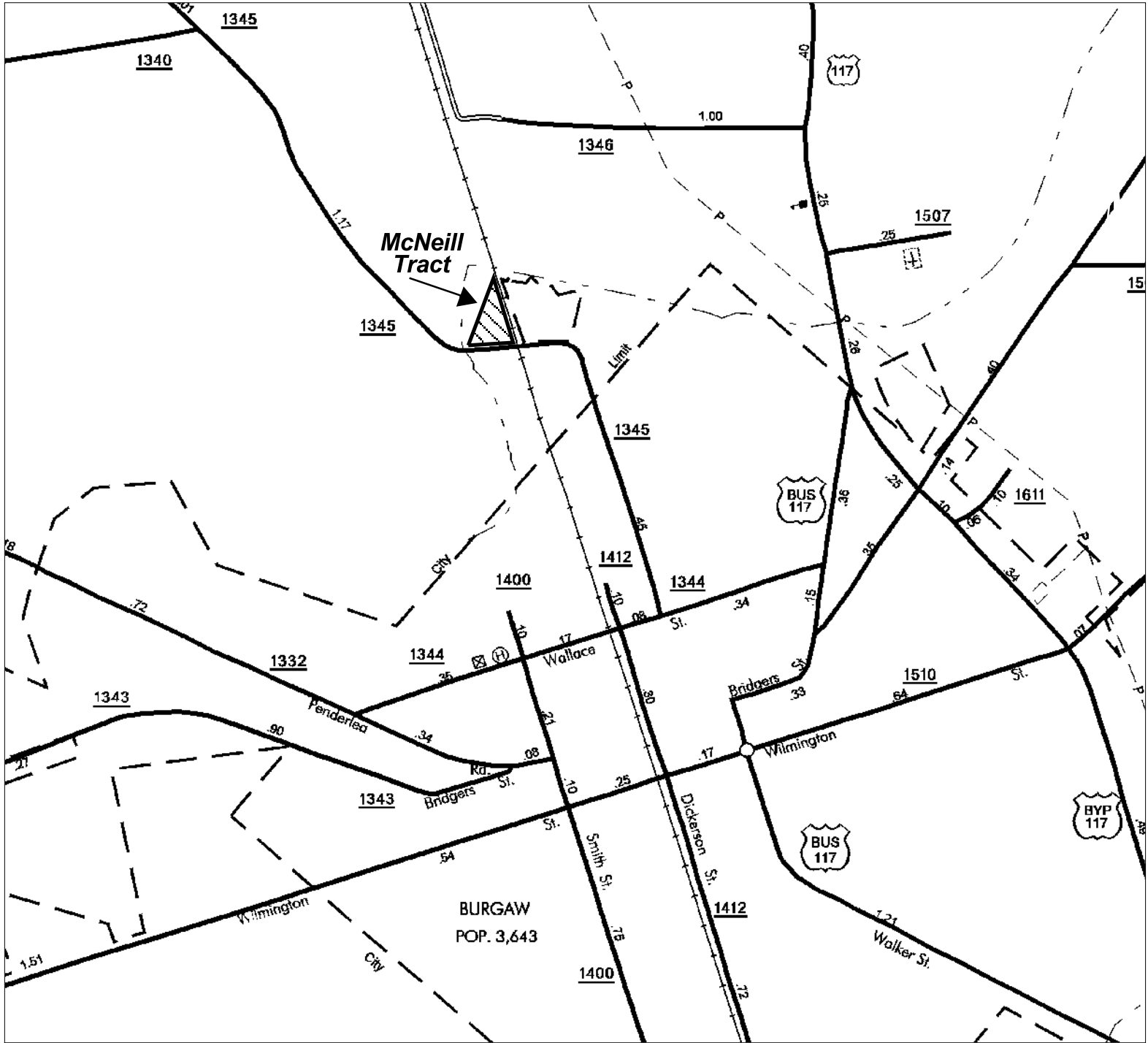

LEGEND	
TRACT BOUNDARY	—————
TOWNSHIP TYPE BOUNDARY	- - - - -
PUBLIC ROAD	=====
PRIVATE ROAD	=====
RAILROAD	—————
POWERLINE	—————
CREEK	~~~~~
CANAL / DITCH
BUILDINGS	■ ■ ■ ■ ■

MCNEILL TRACT

COUNTY: PENDER

TOWNSHIP: BURGAW

NOT TO SCALE