

CHARLES L. TATE, JR. AND ASSOCIATES

CONSULTING FORESTER AND REAL ESTATE BROKER

POST OFFICE BOX 668
LAKE WACCAMAW, NORTH CAROLINA 28450

TELEPHONE: 910-646-3764
FAX: 910-646-4429

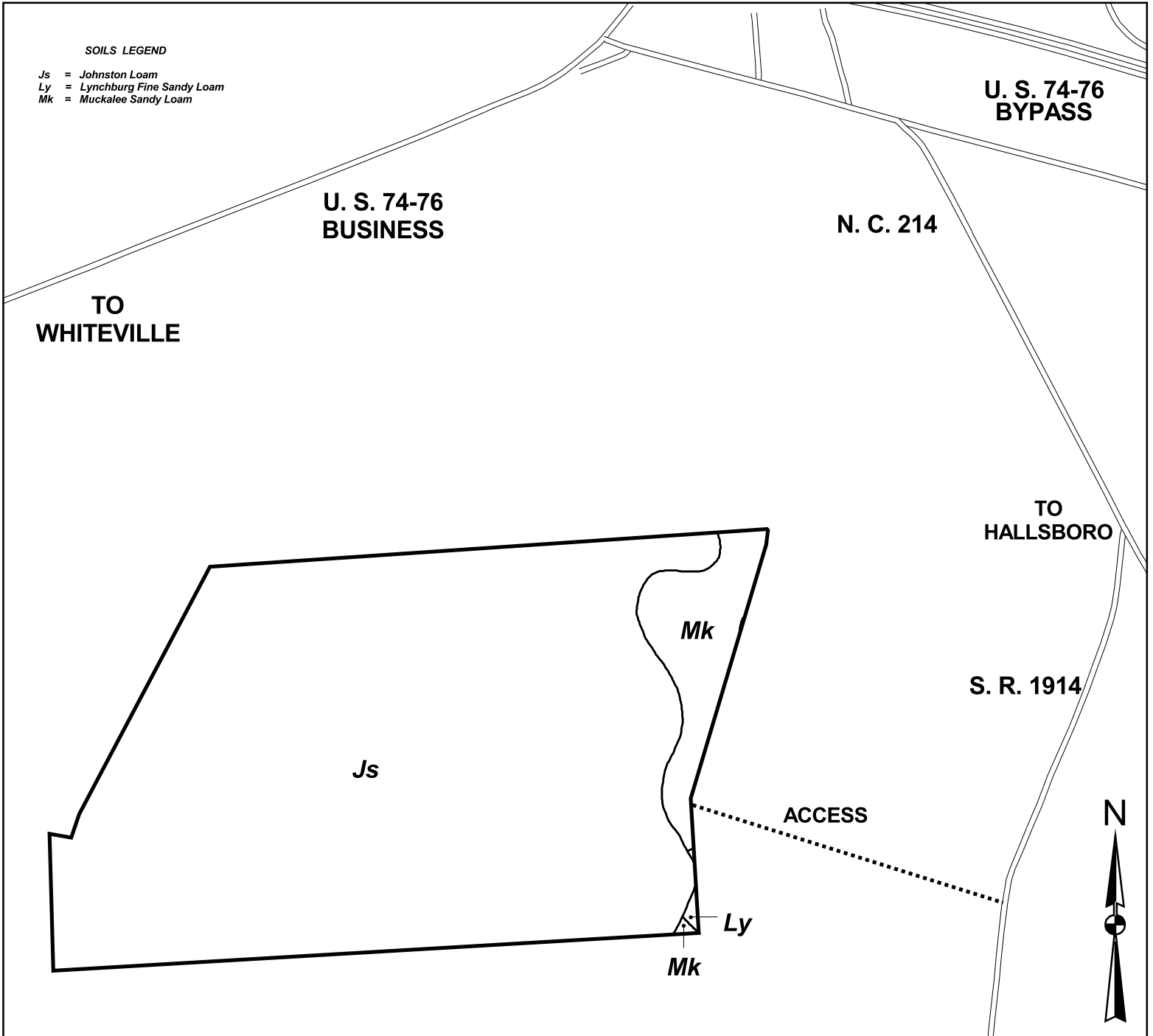

LEGEND	
TRACT BOUNDARY	—————
TIMBER TYPE BOUNDARY	- - - - -
PUBLIC ROAD	===== ===== =====
PRIVATE ROAD	-----
RAILROAD	
POWERLINE	—•—•—•—•—
CREEK	~ ~ ~ ~ ~
CANAL / DITCH	•••••
BUILDINGS	■ ■ ■ ■ ■

ACADEMY TRACT

COUNTY: COLUMBUS

TOWNSHIP: BOGUE

SCALE: 1" = 1,320 FEET

ACRES: 418.0